



Situated in the desirable village of Stainton, this well presented three-bedroom semi-detached home offers modern living across two floors, perfect for first-time buyers, families, or those looking to downsize. The accommodation comprises of: Entrance , leading into a spacious lounge, downstairs toilet, and well equipped dining kitchen. To the first floor the property boasts three well-proportioned bedrooms, ( master with en suite) and modern white and chrome family bathroom. Externally, the enclosed rear garden is laid to lawn with a sunny patio area, driveway to the front providing off-street parking.

**Clover Field Road, Stainton, Middlesbrough, TS8 9FP**

**3 Bed - House - Semi-Detached**

**£185,000**

**EPC Rating: B**

**Council Tax Band: C**

**Tenure: Freehold**



# Clover Field Road, Middlesbrough, TS8 9FP

## GROUND FLOOR

ENTRANCE

LOUNGE

GUEST CLOAKROOM WC

DINING KITCHEN

## FIRST FLOOR

BEDROOM 1

EN SUITE

BEDROOM 2

BEDROOM 3

FAMILY BATHROOM

EXTERNALLY

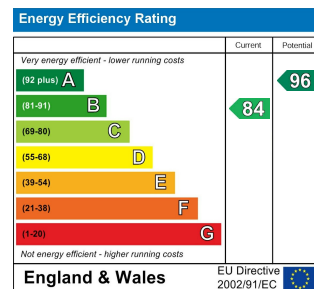
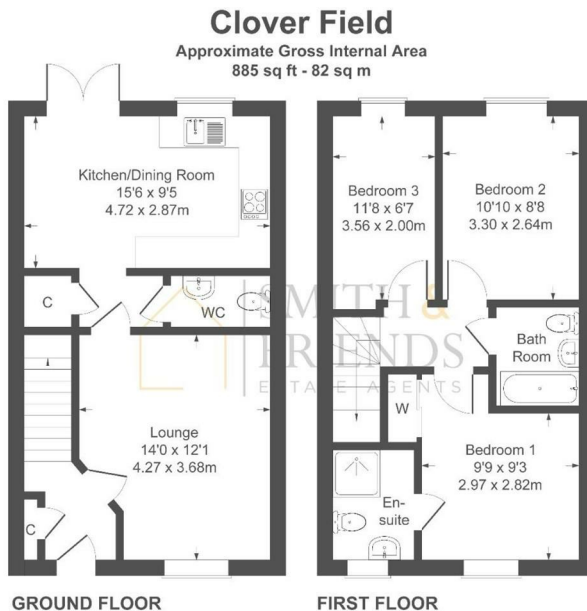

For clarification we wish to inform prospective purchasers that we have prepared these sales particulars as a general guide. We have not carried out a detailed survey, nor tested the services, appliances and specific fittings. Room sizes should not be relied upon for carpets and furnishings, if there are important matters which are likely to affect your decision to buy, please contact us before viewing the property. Smith & Friends Estate Agents can recommend financial services, surveying, conveyancing and removal services to sellers and buyers. Smith & Friends Estate Agents staff may benefit from referral incentives relating to these services.

26 Stokesley Road, Marton, Middlesbrough, TS7 8DX  
01642 313666  
middlesbrough@smith-and-friends.co.uk  
www.smith-and-friends.co.uk

